



LUTKOVNO GLEDALIŠČE LJUBLJANA

Technical Rider

Da te ni sram - Shame on you



Lutkovno gledališče Ljubljana/Ljubljana Puppet Theatre

Krekov trg 2, 1000 Ljubljana, Slovenija

T: +386 (0)1 3000970

Fax: +386 (0)1 3000980

info@lgl.si

www.lgl.si

www.facebook.com/LutkovnoGledalisceLjubljana

Contents

Ljubljana Puppet Theater – Shame on you	1
Contents	2
General Information	3
Staging and Technical Requirements	6
Lighting	6
Sound	6
Video	7
Internet	7
Dressing Rooms	7
Timetable and Contact	7
Appendix 1 – Scenography plan for the “Foyer”	8
Appendix 2 – Scenography plan for the “Project room”	10
Appendix 3 – Scenography plan for the “Rehearsal space”	12

General Information

Intermedia performance

Author of the concept and script: Varja Hrvatin

Authors: Lea Culetto, Varja Hrvatin, Nejc Jezernik, Farah Sara Kurnik, Vid Merlak, Daniel Petković, Mia Skrbina, Jurij Smrke

Cast: ft. Nejc Jezernik, ft. Daniel Petković, ft. Mia Skrbina

Graphic Designer, Video Designer and Set Designer: Farah Sara Kurnik

App Developer: Jurij Smrke

Music: Vid Merlak

Animation and Video Editing: Pavel Enderle

Choreographer: Sebastijan Geč

Language Consultant: Irena Androjna Mencinger

Consultant: Benjamin Zajc

Assistants: Nina Koritnik, Sofija Lavrač Črnivec

Stage Managers, Sound Designers and Video Technicians: Mitja Vasič/Izidor Kozelj

Producer: Alja Cerar Mihajlovič

Lighting Designer: Danilo Korelec

Setup of the stage and costumes: Sandra Birjukov, Monika Colja, Polona Černe, David Klemenčič, Olga Milič, Zlatko Djogić, Zoran Srdić

Shame on You is a performance of endless scrolling and content generation, avatars, emojis, trap, stand-up, music videos and stories that seeks a space without shame at the intersection of the virtual, the fairytale and the present.

Through experimentation with the formats and language of social media, it addresses ingrained feelings of shame and pervasive mutual shaming and shamelessness. Through the original material of a young creative team, it explores when and how shame is born, in what ways it is reproduced and whether it can be overcome at all.

The sense of shame that society instils in individuals from an early age through phrases like "shame on you" and "don't you know any shame", while never offering us valid criteria for shame, is one of the key themes that we are constantly confronted with and struggle with, both individually and collectively. Through questions about the relationship to the body, self-image, insecurity, anxiety, and sexual, social and national identity, the creators of Shame on You want to open up a parallel reality, both material and virtual, intertwined with different symbols and notions of shame, in which different rules, different ideals and, above all, different shame can be established.

The performance materials, set in three equal but theatrically unconventional spaces of the Ljubljana Puppet Theatre, look at shame through the eyes of today's world and place it in the context of the social spaces in which shame is born, and above all in which it is fed and reproduced. The creative team therefore explores and questions home, school, social life

and the social networks that are now fully equal to other elements of life, and by unpacking them, asks the question: 'Is there a place without shame?'

The production was developed within the LGL Theatre Lab, starting with a months-long workshop with teenagers in collaboration with the Dschungel Wien youth theatre from Vienna. During the workshops, the creative team worked with the teenagers to conceptualise the essence of the theme of shame, which was then taken into the second, conceptual part of the creative process, in which the extended team created an intermedia performance.

This takes place in three separate spaces, each of which is used by one of the actors to explore his or her own experience of shame, while all three spaces are connected by an original mobile app, which gives the audience access to all performance spaces and to an extended, augmented virtual space of the performance.

Varja Hrvatin is a dramaturg, playwright and, since 2018, the editor of Teritorij teatra broadcast on Radio Študent. She graduated in dramaturgy and performing arts and received her master's degree in film and television screenwriting from the Academy of Theatre, Radio, Film and Television in Ljubljana. Her dramatic texts have been published in Adept, Dialogues, Literatura, Sodobnost, Maska and November, and her theoretical texts in numerous theatre journals, on the platform Neodvisni and in the magazines Amfiteater, Dialogues and Maska. Her play *It All Started with the Bunny Rabbit*

Goulash (2019) directed by Eva Kokalj premiered at the New Post Office, and was included in the accompanying programme of the 54th Maribor Theatre Festival and the 50th Week of Slovenian Drama. In 2020, she received the award for the best young playwright at the 50th Week of Slovenian Drama and collaborated with the Prešeren Theatre Kranj on the project *Couch Monologues*. In 2021 she staged her first original projects *I Wish the Earth Would Open Up* and *Swallow Me*, which was included in the competition programme of the 57th Maribor Theatre Festival, and *Zelda*, which was included in the accompanying programme of the 52nd Week of Slovenian Drama. In 2022, she co-created *Apophenia/1* with Nina Ramšak Markovič, and is currently working on a series of site-specific performances *La isla bonita*, co-produced by the Sploh Institute and Via Negativa.

The European ConnectUp project involves 14 partners from 10 countries, including theatres, festivals and universities. The lead organisation is Adger University (Academy of Fine Arts) in Norway, which is committed to cutting-edge innovation in education and research. The project is launching an international cultural initiative for the over 12s, aiming to create a counterbalance to the growing social and cultural divide in Europe. Ten theatres with different artistic skills, nine festivals and two universities working in the field of theatre for young people are pooling their skills in a European "diversity union" and planning major investments in audience development. The theatres and festivals are striving to create, at least in their own spaces, a cross-section of society where existing middle-class and marginal audiences meet. As part of the project, the partners are working on co-production performance projects involving teenagers and training theatre mediators to act as a link between the target groups, theatres and schools.

In cooperation with Dschungel Wien and in co-production with Theatre Alpha (Czech Republic) As part of Creative Europe's ConnectUp project

Audiences can simply watch the show or participate actively and anonymously – for that, they will need a smartphone with internet access.

The performance includes lighting effects that may disturb sensitive viewers.

Premiere 25 October 2022, LGL Grand Stage Foyer, LGL Rehearsal Room, LGL Project Room

The show is recommended for audience members aged 15 and upwards. Please notify the company at the earliest opportunity if any of the requirements in this document cannot be met.

Touring personnel

The company tours 3 actors (2 M, 1 F), 6 technicians (1 stage manager and sound engineer, 2 video technicians, 1 lighting technician, 2 set technicians).

Actors: ft. Nejc Jezernik, ft. Daniel Petković, ft. Mia Skrbinac

Stage Manager and Sound Engineer: Izidor Kozelj

Video Technicians: Luka Bernetič, Damir Radončič

Lighting Technician: Danilo Korelec

Set Technicians: Slobodan Ilić + 1 other

Performance

The performance lasts approximately 90 minutes with no interval.

Lights and sound are operated by toured personnel. Both operating positions must have a clear view of the stage. Sound operating position is required. The position cannot be behind glass or in a control box. Please hold off auditorium seats to facilitate this if necessary.

There must be a rehearsal before the performance.

Between two performances there must be at least 1 hour to prepare the stage.

Get-in & get-out

The get-in takes 10 hours together, 8 hours for scenography, 2 hours for light and 6 hours for sound and video. The get-out takes 4 hours. There must be a rehearsal before the performance.

The venue will need to provide a minimum of two skilled technicians for get-in and get-out and for set up, one specialized in sound, one in video and one in lighting. The technicians should be competent at rigging/hanging set parts.

Staging and Technical Requirements

Stage and Set-Up

- The performance area is made up of three separate spaces. In our theatre they are named: Foyer, Project room and Rehearsal space.
- Foyer dimensions: 5,2 m W x 10 m D x 3,9 m H
- Project room dimensions: 4,5 m W x 11 m D x 3,1 m H
- Rehearsal space dimensions: 5,37 m W x 6,78 m D x 3,5 m H
- Each performance space has a specific set-up, see appendices 1-3.
- Each performance space requires raked seating, made up of stage units. See appendices 1-3.
- A full black out is required.
- In each space there must be a well functioning wi-fi internet for the spectators (50Mbps/50Mbps)!

Stage items provided by venue

This performance requires 10 stage units to be provided by the venue for the grandstand for spectators:

- 2x stage unit 2m x 1 m x 0,2 m for the Foyer
- 2x stage unit 2m x 1 m x 0,4 m for the Foyer
- 1x stage unit 2m x 1 m x 0,2 m for the Project room
- 1x stage unit 2m x 1 m x 0,4 m for the Project room
- 1x stage unit 2m x 1 m x 0,6 m for the Project room
- 1x stage unit 2m x 1 m x 0,4 m for the Rehearsal space
- 1x stage unit 2m x 1 m x 0,4 m for the Rehearsal space
- 1x stage unit 2m x 1 m x 0,8 m for the Rehearsal space

Lighting

Lighting control and reflectors provided by venue:

- 3x halogen flood light 150w
- 3x 1 channel light regulator
- Cables, dividers, small materials

The company brings it's owns gels.

Sound

Sound equipment provided by venue:

- 2x speaker for the "Foyer"
- 1x speaker for the "Production room"
- 1x speaker for the "Rehearsal space"

Video

Video equipment provided by venue:

- 1x Projector type Benq MW632ST for the Rehearsal space
- 1x Projector type Benq EH600 for the Foyer
- 1x Projector type Epson EB-225OU for the Project room

If there will be surtitles, you need to contact us in advance.

Internet

In each space there must be a well-functioning wi-fi internet for the spectators (100Mbps/100Mbps)!

Dressing Rooms

Please provide:

- Two dressing rooms for the actors (2 male, 1 female). These should be non-smoking and private.
- Makeup room
- Showers with hot water
- Tea, Coffee and Fruit are desirable
- 1 x Crate of 500ml Still Water
- If providing meals please note a number of company members are vegetarian.

Timetable, Transport and Contact

The set up takes approximately 10 hours. There must be a rehearsal before the performance. The take down takes 4 hours.

Scenography travels with 1 Crafter vans.

For any information about technical details please contact:
Jure Žnidaršič
Technical manager
e-mail: tehnika@lgl.si
tel.: +38613000991

Appendix 1 – Scenography plan for the “ Foyer”



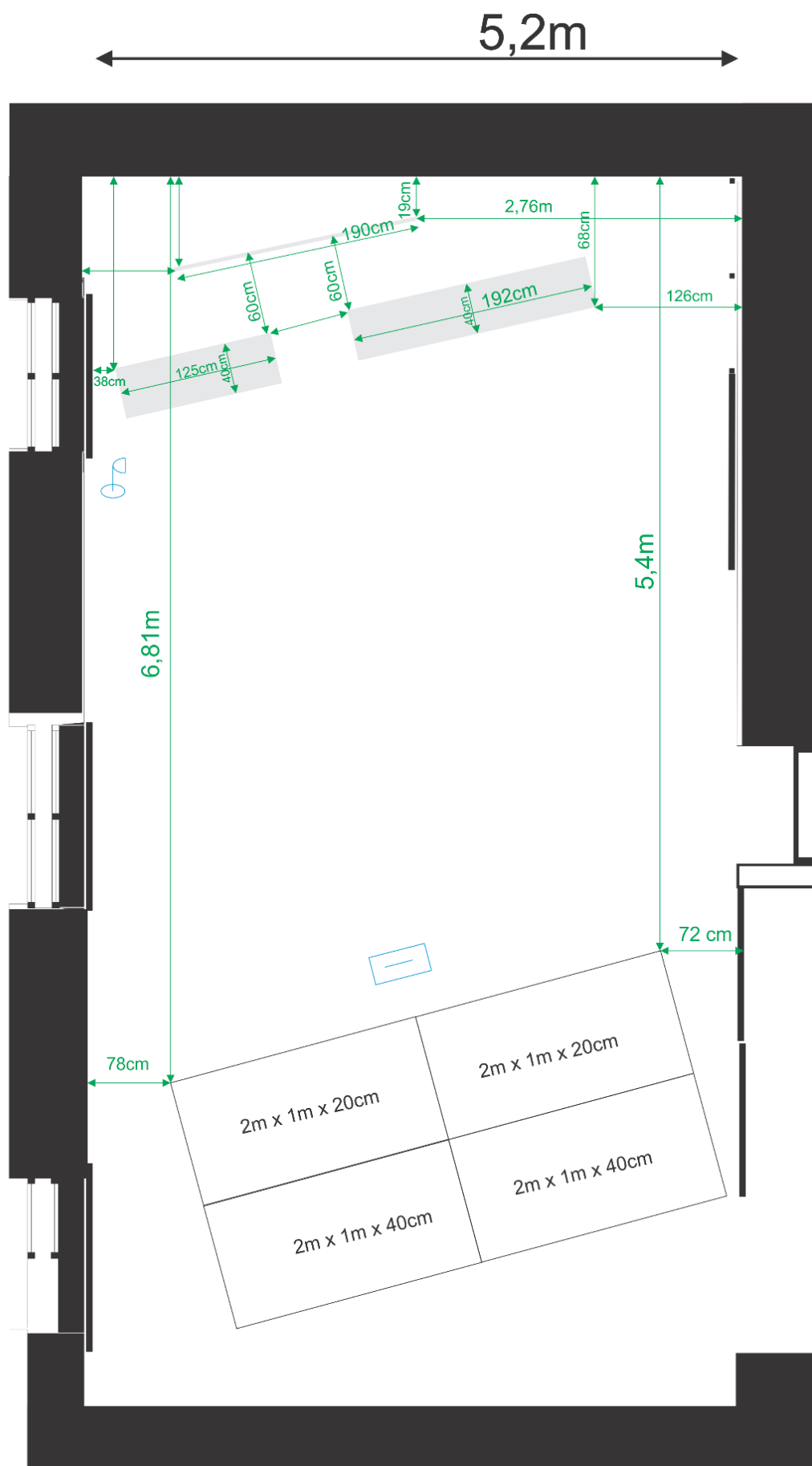

Appendix 2 – Scenography plan for the “Project room”



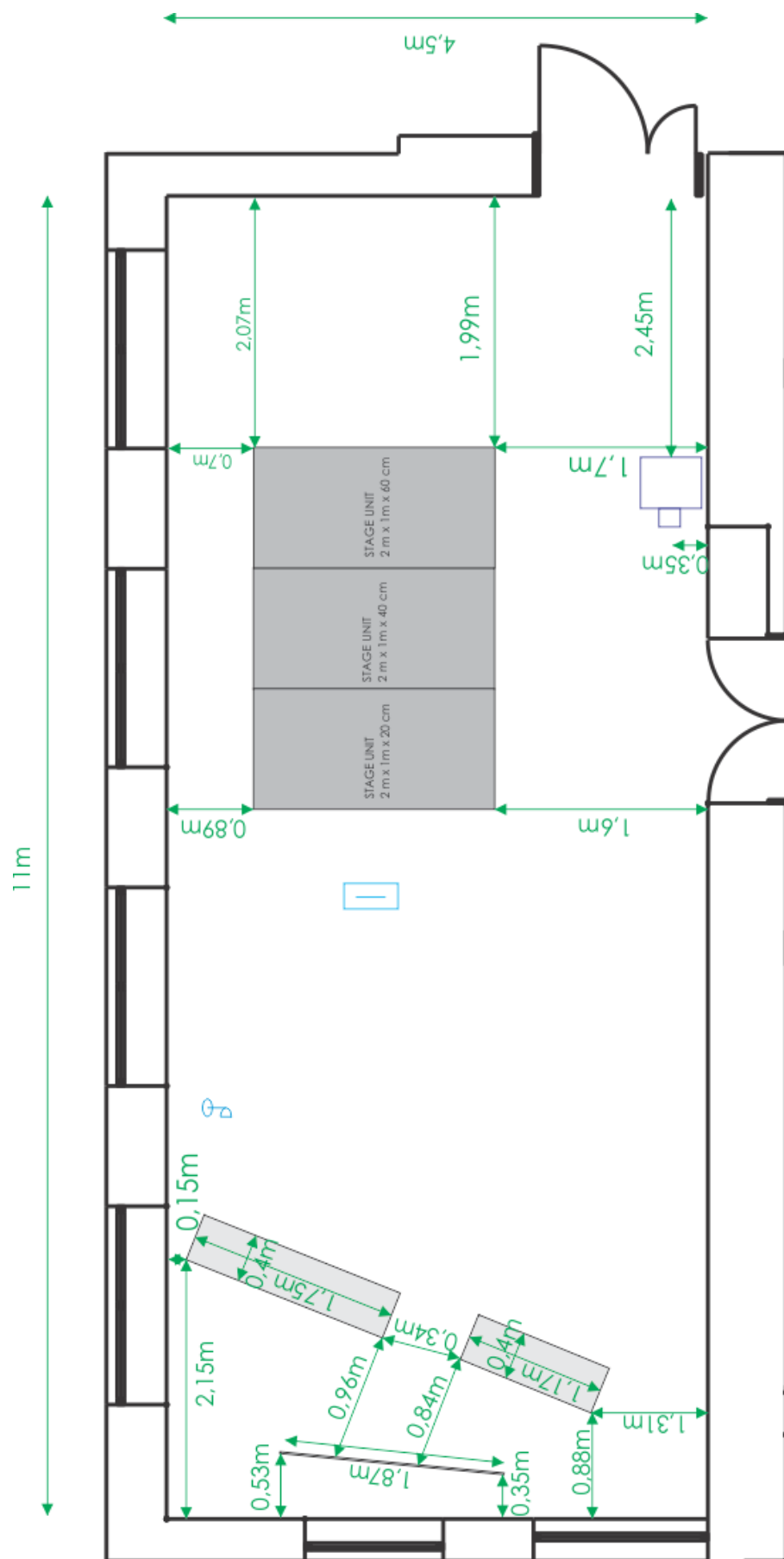

Appendix 3 – Scenography plan for the “Rehearsal space”



